

**NATIONAL REGISTER OF HISTORIC PLACES
INVENTORY - NOMINATION FORM**

(Type all entries - complete applicable sections)

STATE: Rhode Island	
COUNTY: Providence	
FOR NPS USE ONLY	
ENTRY NUMBER	DATE

1. NAME

COMMON:
Burlingame-Noon House

AND/OR HISTORIC:

2. LOCATION

STREET AND NUMBER:
3261 Mendon Road

CITY OR TOWN:
Cumberland

STATE Rhode Island, 02854	CODE 114	COUNTY: Providence	CODE 007
------------------------------	-------------	-----------------------	-------------

3. CLASSIFICATION

CATEGORY (Check One)	OWNERSHIP	STATUS	ACCESSIBLE TO THE PUBLIC
<input type="checkbox"/> District <input type="checkbox"/> Site <input type="checkbox"/> Object <input checked="" type="checkbox"/> Building <input type="checkbox"/> Structure	<input type="checkbox"/> Public <input checked="" type="checkbox"/> Private <input type="checkbox"/> Both	<input checked="" type="checkbox"/> Occupied <input type="checkbox"/> Unoccupied <input type="checkbox"/> Preservation work In progress	Yes: <input type="checkbox"/> Restricted <input type="checkbox"/> Unrestricted <input checked="" type="checkbox"/> No
PRESENT USE (Check One or More as Appropriate)			
<input type="checkbox"/> Agricultural <input type="checkbox"/> Commercial <input type="checkbox"/> Educational <input type="checkbox"/> Entertainment	<input type="checkbox"/> Government <input type="checkbox"/> Industrial <input type="checkbox"/> Military <input type="checkbox"/> Museum	<input type="checkbox"/> Park <input checked="" type="checkbox"/> Private Residence <input type="checkbox"/> Religious <input type="checkbox"/> Scientific	<input type="checkbox"/> Transportation <input type="checkbox"/> Other (Specify) _____ _____

4. OWNER OF PROPERTY

OWNER'S NAME:
Charles E. and Lucille D. White

STREET AND NUMBER:
3261 Mendon Road

CITY OR TOWN:
Cumberland

STATE: Rhode Island, 02854	CODE 114
-------------------------------	-------------

5. LOCATION OF LEGAL DESCRIPTION

COURTHOUSE, REGISTRY OF DEEDS, ETC.:
Cumberland Town Clerk

STREET AND NUMBER:
Town Hall, 45 Broad Street

CITY OR TOWN:
Cumberland

STATE: Rhode Island, 02854	CODE 114
-------------------------------	-------------

6. REPRESENTATION IN EXISTING SURVEYS

TITLE OF SURVEY:
Not so represented

DATE OF SURVEY: Federal State County Local

DEPOSITORY FOR SURVEY RECORDS:

STREET AND NUMBER:

CITY OR TOWN: STATE: CODE

SEE INSTRUCTIONS

STATE: COUNTY: ENTRY NUMBER: DATE: FOR NPS USE ONLY

7. DESCRIPTION

CONDITION	(Check One)					
	<input checked="" type="checkbox"/> Excellent	<input type="checkbox"/> Good	<input type="checkbox"/> Fair	<input type="checkbox"/> Deteriorated	<input type="checkbox"/> Ruins	<input type="checkbox"/> Unexposed
	(Check One)			(Check One)		
	<input type="checkbox"/> Altered	<input checked="" type="checkbox"/> Unaltered		<input type="checkbox"/> Moved	<input checked="" type="checkbox"/> Original Site	

DESCRIBE THE PRESENT AND ORIGINAL (If known) PHYSICAL APPEARANCE

This building, still a dwelling but no longer a farmhouse, is today in external appearance a modest but dignified smaller structure--two-and-a-half-storeys high, gable-roofed and clapboarded--of the Greek Revival period, and accordingly trimmed. In its original form, however, it could be given a date of c. 1800-1815, and it was, as roofline evidence seen against the chimney within the attic indicates, a one-and-a-half-storey house of "Cape Cod cottage" type: timber-framed upon a low stone foundation, as is also an ell later than the original cottage. Floor-plan is the traditional one dictated by a centre chimney behind a small entry- and stair-hall and serving hearths in three major rooms of each floor. The house faces south-west, presenting a five-bay frontal elevation, and attached at its north-east corner is a storey-and-a-half ell running off towards the rear and containing one large space below and a (now remodelled) garret above.

The purely functional and later all remains barren in its exterior treatment, while the original and much earlier storey-and-a-half dwelling probably at first had modest Federal-period trim outside, consonant with that remaining inside on its first floor. When the house was heightened by one storey in the 1830's or 1840's its outside was "modernised and improved" by the application of simple Greek Revival trim, a thing often done by many rural families who found themselves prospering by that time. So, we now see the former cottage turned into a two-and-a-half-storey house, with panelled pilasters applied to its corners and a new front doorway with sidelights, pilasters and a modest entablature. Old, small-paned window sash was then replaced on the more conspicuous elevations by six-over-six sash. From this time would date the ell which can be entered from the north-east portion of the heightened house. Added also at this time was a wooden fence to separate the property from increasingly-busy Mendon Road; this has square boarded piers with projecting flat caps, spaced to contain stretches of slender pickets.

Since its enlargement, the house has remained remarkably intact, not only on its exterior but also internally, in both plan and trim. On its first floor one finds the expected five-room, central chimney plan. The living-room has very good Federal-period woodwork. Across the greater part of the rear of the house runs what was apparently, from the quality of its trim, always the dining-room. The original kitchen or "keeping-room," rather unconventionally placed at an end of the house, retains its wide cooking-hearth with ovens at one side and has a finer trim than was generally to be found in kitchens. Up until recent minor changes the second-floor arrangement was very similar to that below, except that there were three large rooms and only one smaller one rather than the five to be found downstairs. Trim on this added floor displays characteristics of the Greek Revival style in contrast to the Federal-style woodwork below. From the second floor a small and narrow stair runs to the attic or garret under the gable, a space plastered between timbers but not divided into rooms. The 17' by 28' ell attached to the

(See Continuation Sheet.)

SEE INSTRUCTIONS

NATIONAL REGISTER OF HISTORIC PLACES
INVENTORY - NOMINATION FORM

(Continuation Sheet)

STATE Rhode Island	
COUNTY Providence	
FOR NPS USE ONLY	
ENTRY NUMBER	DATE

(Number all entries)

7. Description.

house at its north-east has its gable- or ridge-line perpendicular to that of the main dwelling and except for its necessary corner conjunction with the house is off to one side of the latter.

In the 1840's (probably when it was enlarged and re-trimmed) and 1850's, the house was in ownership of the Burlingame family; its earlier proprietor(s) and exact building date have not yet been traced. In 1866 it came into possession of Patrick Noon, and Noon lived there--apparently making no changes except for the introduction of essential plumbing and electrical conveniences--until 1971. Under the present new ownership, necessary repair work and the improvement of utilities was undertaken in 1972, but the house has undergone no structural or greatly visible change.

SIGNIFICANCE

PERIOD (Check One or More as Appropriate)

- | | | | |
|--|---------------------------------------|--|---------------------------------------|
| <input type="checkbox"/> Pre-Columbian | <input type="checkbox"/> 16th Century | <input type="checkbox"/> 18th Century | <input type="checkbox"/> 20th Century |
| <input type="checkbox"/> 15th Century | <input type="checkbox"/> 17th Century | <input checked="" type="checkbox"/> 19th Century | |

SPECIFIC DATE(S) (If Applicable and Known) C. 1800 ff.

AREAS OF SIGNIFICANCE (Check One or More as Appropriate)

- | | | | |
|--|---|--|---|
| <input type="checkbox"/> Aboriginal | <input type="checkbox"/> Education | <input type="checkbox"/> Political | <input type="checkbox"/> Urban Planning |
| <input type="checkbox"/> Prehistoric | <input type="checkbox"/> Engineering | <input type="checkbox"/> Religion/Philosophy | <input checked="" type="checkbox"/> Other (Specify) |
| <input type="checkbox"/> Historic | <input type="checkbox"/> Industry | <input type="checkbox"/> Science | <u>Social history:</u> |
| <input type="checkbox"/> Agriculture | <input type="checkbox"/> Invention | <input type="checkbox"/> Sculpture | <u>rural villages</u> |
| <input checked="" type="checkbox"/> Architecture | <input type="checkbox"/> Landscape Architecture | <input type="checkbox"/> Social/Humanitarian | _____ |
| <input type="checkbox"/> Art | <input type="checkbox"/> Literature | <input type="checkbox"/> Theater | _____ |
| <input type="checkbox"/> Commerce | <input type="checkbox"/> Military | <input type="checkbox"/> Transportation | _____ |
| <input type="checkbox"/> Communications | <input type="checkbox"/> Music | | _____ |
| <input type="checkbox"/> Conservation | | | _____ |

STATEMENT OF SIGNIFICANCE

In view of the changes which have taken place along Mendon Road in Cumberland, one first thinks of the Burlingame-Noon house and what remains of its land (a little more than a half acre) as being an important, surviving and typical "sliver" of the original farming layouts and domestic architecture that the whole district once displayed, and of which almost nothing remains now. This had long been an agricultural area, pierced by a main highroad. Stretching back on either side of Mendon Road were the acreages of farm families, well-rooted in the section and for generations not attracted away from their homes and fields. They were able to have good local housewrights and carpenters to build and trim their XVIII- and early XIX-Century dwellings. Later, as they prospered increasingly in the War of 1812-Civil War period, they would employ the same to enlarge and improve their houses, outbuildings and accessories.

The Burlingame-Noon house shows the more happy results of such "improvements." Here they were accomplished in the period of the Greek Revival and were done with simple and handsome restraint and economy: the new entrance door, the upstairs mantels, the fronting fence. The rear ell adds size and interest to the house-arrangement but was kept purely functional and undecorated (it is thought perhaps to have housed a village store).

It is fortunate that in this particular dwelling almost no changes were made by successively-occupying generations over more than one hundred and twenty-five years. The remaining land immediately surrounding the house has not changed; what is left is open, gently rolling and has some large old trees; whatever outbuildings there may have been when the property was larger have not survived, due to nearby real-estate enterprises. The house, however, still has a comfortable yard. The new owners have undertaken maximum restoration and minimum interior change. The Burlingame-Noon house is one of the very few houses and sites remaining to show what the Mendon Road part of Cumberland once was like.

SEE INSTRUCTIONS

9. MAJOR BIBLIOGRAPHICAL REFERENCES

[Faint, illegible text in this section]

10. GEOGRAPHICAL DATA

LATITUDE AND LONGITUDE COORDINATES DEFINING A RECTANGLE LOCATING THE PROPERTY			O R	LATITUDE AND LONGITUDE COORDINATES DEFINING THE CENTER POINT OF A PROPERTY OF LESS THAN TEN ACRES	
CORNER	LATITUDE	LONGITUDE		LATITUDE	LONGITUDE
	Degrees Minutes Seconds	Degrees Minutes Seconds		Degrees Minutes Seconds	Degrees Minutes Seconds
NW	° ' "	° ' "		41 ° 58 ' 32.31" N	71 ° 27 ' 25.58" W
NE	° ' "	° ' "			
SE	° ' "	° ' "			
SW	° ' "	° ' "			

APPROXIMATE ACREAGE OF NOMINATED PROPERTY: Slightly more than one-half acre

LIST ALL STATES AND COUNTIES FOR PROPERTIES OVERLAPPING STATE OR COUNTY BOUNDARIES

STATE:	CODE	COUNTY	CODE

11. FORM PREPARED BY

NAME AND TITLE:
Richard B. Harrington, Consultant

ORGANIZATION: **Rhode Island Historical Preservation Commission** DATE: **April 14, 1973**

STREET AND NUMBER:
John Brown House, 52 Power Street

CITY OR TOWN: **Providence** STATE: **Rhode Island, 02906** CODE: **44**

12. STATE LIAISON OFFICER CERTIFICATION NATIONAL REGISTER VERIFICATION

As the designated State Liaison Officer for the National Historic Preservation Act of 1966 (Public Law 89-665), I hereby nominate this property for inclusion in the National Register and certify that it has been evaluated according to the criteria and procedures set forth by the National Park Service. The recommended level of significance of this nomination is:

National State Local

Name _____

Title _____

Date _____

I hereby certify that this property is included in the National Register.

Chief, Office of Archeology and Historic Preservation

Date _____

ATTEST:

Keeper of The National Register

Date _____

SEE INSTRUCTIONS



UNITED STATES DEPARTMENT OF THE INTERIOR
NATIONAL PARK SERVICE

NATIONAL REGISTER OF HISTORIC PLACES
PROPERTY PHOTOGRAPH FORM

(Type all entries - attach to or enclose with photograph)

1. NAME		
COMMON	AND/OR HISTORIC	NUMERIC CODE (Assigned by NPS)
Burlingame-Noon House		

2. LOCATION		
STATE	COUNTY	TOWN
Rhode Island	Providence	Cumberland

STREET AND NUMBER		
3261 Mendon Road		

3. PHOTO REFERENCE		
PHOTO CREDIT	DATE	NEGATIVE FILED AT
Clifford M. Renshaw, III	July, 1973	Rhode Island Historical Preservation Com- mission, John Brown House,

4. IDENTIFICATION		
DESCRIBE VIEW, DIRECTION, ETC.		
Exterior from the south-east.		

52 Power Street, Providence,
Rhode Island, 02906



UNITED STATES DEPARTMENT OF THE INTERIOR
NATIONAL PARK SERVICE
NATIONAL REGISTER OF HISTORIC PLACES
PROPERTY PHOTOGRAPH FORM

(Type all entries - attach to or enclose with photograph)

1. NAME		
COMMON Burlingame-Noon House	AND/OR HISTORIC	NUMERIC CODE (Assigned by NPS)
2. LOCATION		
STATE Rhode Island	COUNTY Providence	TOWN Cumberland
STREET AND NUMBER 3261 Mendon Road		
3. PHOTO REFERENCE		
PHOTO CREDIT Clifford M. Renshaw, III	DATE July, 1973	NEGATIVE FILED AT Rhode Island Historical Preservation Com- mission, John Brown House, 52 Power Street, Providence, Rhode Island, 02906
4. IDENTIFICATION		
DESCRIBE VIEW, DIRECTION, ETC.		

Detail of parlor, showing mantel and wainscot on east wall.



UNITED STATES DEPARTMENT OF THE INTERIOR
NATIONAL PARK SERVICE

NATIONAL REGISTER OF HISTORIC PLACES
PROPERTY PHOTOGRAPH FORM

(Type all entries - attach to or enclose with photograph)

1. NAME		
COMMON	AND/OR HISTORIC	NUMERIC CODE (Assigned by NPS)
Burlingame-Noon House		

2. LOCATION		
STATE	COUNTY	TOWN
Rhode Island	Providence	Cumberland

STREET AND NUMBER		
3261 Mendon Road		

3. PHOTO REFERENCE		
PHOTO CREDIT	DATE	NEGATIVE FILED AT
Clifford M. Renshaw, III	July, 1973	Rhode Island Historical Preservation Com- mission, John Brown House,

4. IDENTIFICATION	
DESCRIBE VIEW, DIRECTION, ETC.	
	52 Power Street, Providence, Rhode Island, 02906

West wall of former kitchen (present dining-room), showing original cooking-hearth with ovens concealed at right, and original hardware.

UNITED STATES
DEPARTMENT OF THE INTERIOR
GEOLOGICAL SURVEY

S
WIL

71°30' 500 000 FEET (R.I.) WOOSOCKET (CITY HALL) 1.2 MI. 1 MI. TO R.I. II 295 000 m. E. 296 27°30' 297

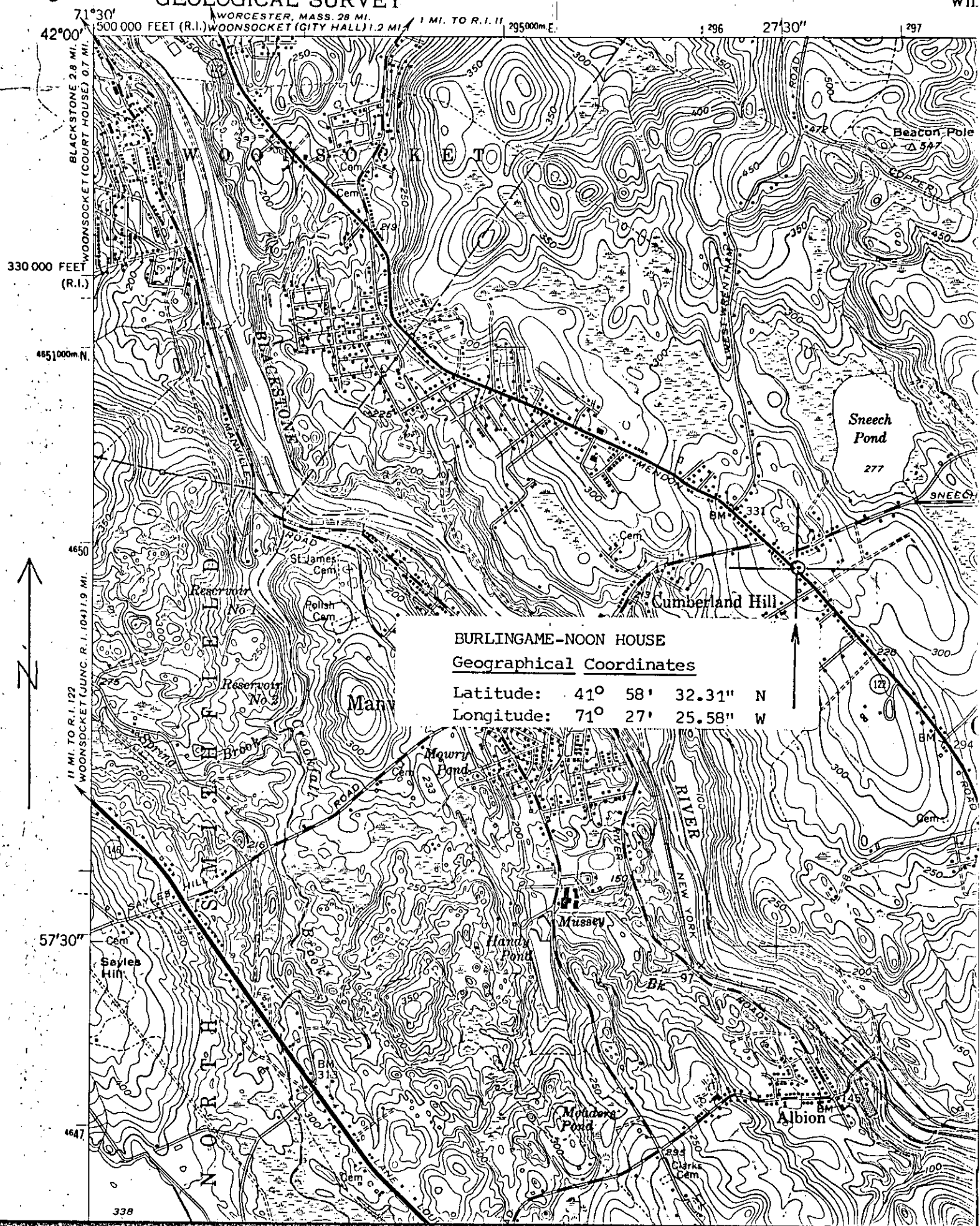

BURLINGAME-NOON HOUSE
Geographical Coordinates

Latitude: 41° 58' 32.31" N
Longitude: 71° 27' 25.58" W

BLACKSTONE 28 MI.
WOOSOCKET (COURT HOUSE) 0.7 MI.
330 000 FEET (R.I.)
455 1000 m.
4650
11 MI. TO R.I. 122
WOOSOCKET (JUNC. R. I. 104) 1.9 MI.
57°30'
4647
338

NATIONAL REGISTER OF HISTORIC PLACES
PROPERTY MAP FORM

(Type all entries - attach to or enclose with map)

STATE Rhode Island	
COUNTY Providence	
FOR NPS USE ONLY	
ENTRY NUMBER	DATE

SEE INSTRUCTIONS

1. NAME

COMMON: Burlingame-Noon House
AND/OR HISTORIC:

2. LOCATION

STREET AND NUMBER:
3261 Mendon Road

CITY OR TOWN:
Cumberland

STATE:
Rhode Island

CODE
44

COUNTY:
Providence

CODE
007

3. MAP REFERENCE

SOURCE:
U. S. Geological Survey

SCALE: 1: 24,000

DATE: 1949

4. REQUIREMENTS

TO BE INCLUDED ON ALL MAPS

1. Property boundaries where required.
2. North arrow.
3. Latitude and longitude reference.