

NATIONAL REGISTER OF HISTORIC PLACES
INVENTORY - NOMINATION FORM

(Type all entries - complete applicable sections)

STATE: <u>Rhode Island</u>	
COUNTY: <u>Washington</u>	
FOR NPS USE ONLY	
ENTRY NUMBER	DATE

1. NAME

COMMON:
Casey (Silas) Farm

AND/OR HISTORIC:

2. LOCATION

STREET AND NUMBER:
Boston Neck Road, 0.3 miles north of Ferry Road, Saunderstown

CITY OR TOWN:
North Kingstown

STATE <u>Rhode Island, 02847</u>	CODE <u>44</u>	COUNTY: <u>Washington</u>	CODE <u>009</u>
-------------------------------------	-------------------	------------------------------	--------------------

3. CLASSIFICATION

CATEGORY (Check One)	OWNERSHIP	STATUS	ACCESSIBLE TO THE PUBLIC
<input checked="" type="checkbox"/> District <input type="checkbox"/> Building <input type="checkbox"/> Site <input type="checkbox"/> Structure <input type="checkbox"/> Object	<input type="checkbox"/> Public <input checked="" type="checkbox"/> Private <input type="checkbox"/> Both	Public Acquisition: <input type="checkbox"/> In Process <input type="checkbox"/> Being Considered	<input checked="" type="checkbox"/> Occupied <input type="checkbox"/> Unoccupied <input type="checkbox"/> Preservation work in progress
PRESENT USE (Check One or More as Appropriate)			
<input checked="" type="checkbox"/> Agricultural <input type="checkbox"/> Commercial <input type="checkbox"/> Educational <input type="checkbox"/> Entertainment	<input type="checkbox"/> Government <input type="checkbox"/> Industrial <input type="checkbox"/> Military <input type="checkbox"/> Museum	<input type="checkbox"/> Park <input checked="" type="checkbox"/> Private Residence <input type="checkbox"/> Religious <input type="checkbox"/> Scientific	<input type="checkbox"/> Transportation <input checked="" type="checkbox"/> Other (Specify) <u>House-Museum</u>
Yes: <input checked="" type="checkbox"/> Restricted <input type="checkbox"/> Unrestricted <input type="checkbox"/> No			

4. OWNER OF PROPERTY

OWNER'S NAME:
Society for the Preservation of New England Antiquities

STREET AND NUMBER:
141 Cambridge Street

CITY OR TOWN:
Boston

STATE:
Massachusetts, 02114

CODE:
25

5. LOCATION OF LEGAL DESCRIPTION

COURTHOUSE, REGISTRY OF DEEDS, ETC.:
North Kingstown Town Hall

STREET AND NUMBER:
80 Boston Neck Road

CITY OR TOWN:
North Kingstown

STATE:
Rhode Island, 02852

CODE:
44

6. REPRESENTATION IN EXISTING SURVEYS

TITLE OF SURVEY:
Historic American Buildings Survey

DATE OF SURVEY: 1957 Federal State County Local

DEPOSITORY FOR SURVEY RECORDS:
Library of Congress

STREET AND NUMBER:
Independence Avenue and 1st Street, S. E.

CITY OR TOWN:
Washington

STATE:
District of Columbia

CODE:
11

SEE INSTRUCTIONS

STATE:
COUNTY:
ENTRY NUMBER
DATE

FOR NPS USE ONLY

7. DESCRIPTION

CONDITION	(Check One)					
	<input type="checkbox"/> Excellent	<input checked="" type="checkbox"/> Good	<input type="checkbox"/> Fair	<input type="checkbox"/> Deteriorated	<input type="checkbox"/> Ruins	<input type="checkbox"/> Unexposed
	(Check One)			(Check One)		
	<input checked="" type="checkbox"/> Altered	<input type="checkbox"/> Unaltered	<input type="checkbox"/> Moved	<input checked="" type="checkbox"/> Original Site		

DESCRIBE THE PRESENT AND ORIGINAL (If known) PHYSICAL APPEARANCE

The Silas Casey Farm is a well-preserved, still-functioning example of an early eighteenth-century South County farm. At the heart of its acreage stands the Casey house, built by Silas Casey's father-in-law, Daniel Coggeshall between 1725 and 1750. To the north of the house a number of farm outbuildings, including a barn and various connecting sheds which house riding-horses, dairy cows, chickens, and other farm animals.

While the outbuildings have been replaced through the years, the Silas Casey "mansion house," as old records call it, has remained substantially as it was first built. It is a simple two-story clapboarded dwelling, timber-framed upon a very low cellar foundation, with four bays across its south or entrance front. Its roof is of a typical early (c.1720-1750) gable-on-hip-form.

Originally, the house must have been of the five-room, central-chimney plan, having two large rooms opening laterally off the front stair hall and three smaller rooms to the rear. On the first floor the original partitions in the rear have been removed to create one large room and an adjoining bath. A one-room, one-story ell has been projected from the north wall at the east end of the house--probably fairly early in its history.

The interior detail of the house is severely plain. The small front entry contains a stairway rising in three short runs; it has railings molded only on the outer face and sawn, flat S-shaped balusters and turnip finials, and the two posts are finished with heavy elongated acorn drops also of very early eighteenth century form. Corner-posts are finished with three-quarter-round beaded moldings, and panelling is restricted to the fireplace walls. On the first floor, the fireplace treatments in the two front rooms consist of a panelled cupboard to the right and a glass-doored cupboard above--the back of the latter slanting against the tapering chimney. Upstairs, the southeast room has a bolection-molded overmantel panel (the overmantel of the southwest room is missing--if, indeed, there ever was one); both rooms have bolection-molded chair-rails, which may have been found throughout the house originally.

SEE INSTRUCTIONS

NATIONAL REGISTER OF HISTORIC PLACES
INVENTORY - NOMINATION FORM

(Continuation Sheet)- 1

STATE Rhode Island	
COUNTY Washington	
FOR NPS USE ONLY	
ENTRY NUMBER	DATE

(Number all entries)

7. Description

Site plan for the farm complex

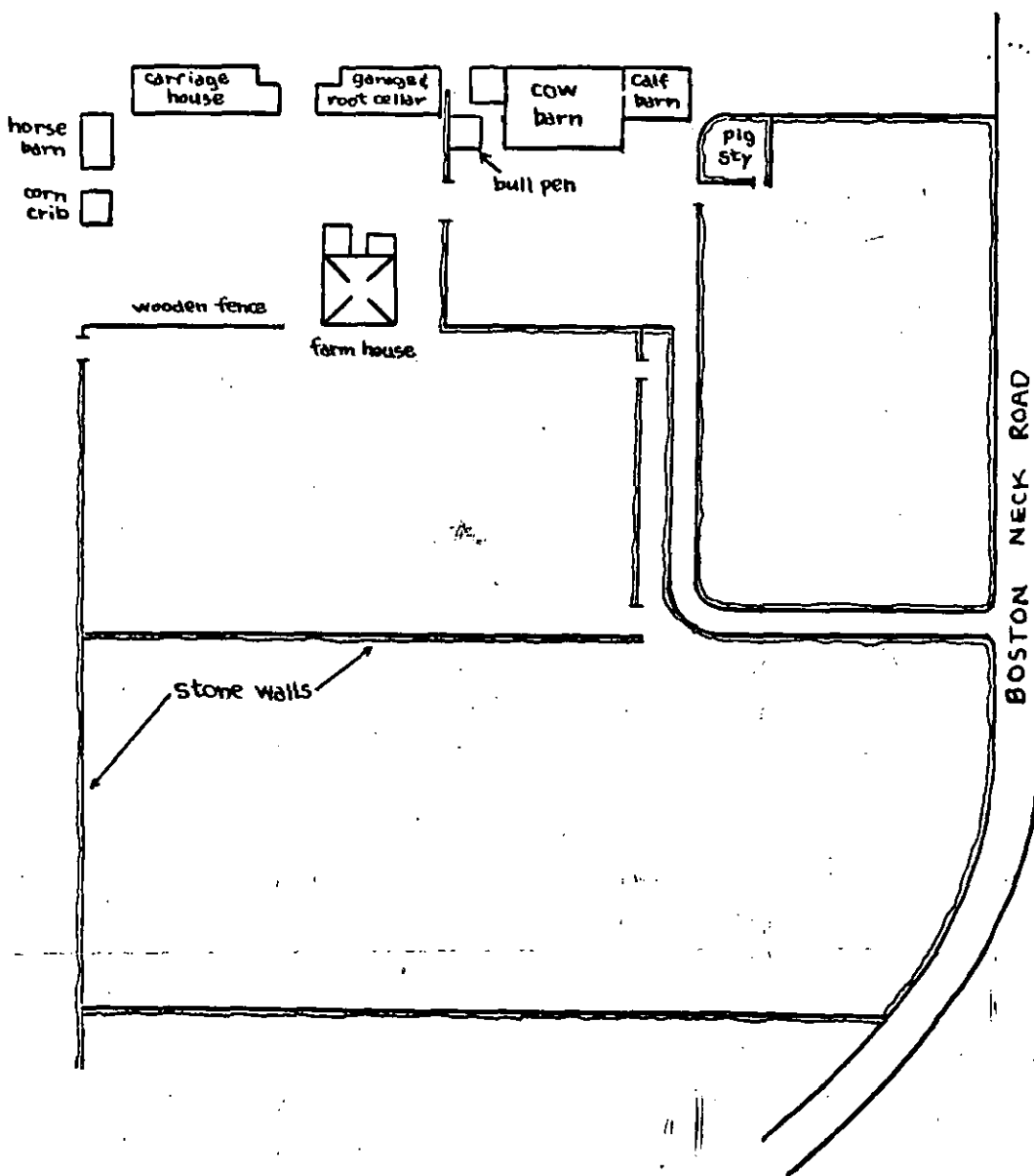

3. SIGNIFICANCE

PERIOD (Check One or More as Appropriate)

<input type="checkbox"/> Pre-Columbian	<input type="checkbox"/> 16th Century	<input checked="" type="checkbox"/> 18th Century	<input type="checkbox"/> 20th Century
<input type="checkbox"/> 15th Century	<input type="checkbox"/> 17th Century	<input type="checkbox"/> 19th Century	

SPECIFIC DATE(S) (If Applicable and Known) c. 1725-1750

AREAS OF SIGNIFICANCE (Check One or More as Appropriate)

<input type="checkbox"/> Aboriginal	<input type="checkbox"/> Education	<input type="checkbox"/> Political	<input type="checkbox"/> Urban Planning
<input type="checkbox"/> Prehistoric	<input type="checkbox"/> Engineering	<input type="checkbox"/> Religion/Philosophy	<input type="checkbox"/> Other (Specify) _____
<input type="checkbox"/> Historic	<input type="checkbox"/> Industry	<input type="checkbox"/> Science	_____
<input checked="" type="checkbox"/> Agriculture	<input type="checkbox"/> Invention	<input type="checkbox"/> Sculpture	_____
<input checked="" type="checkbox"/> Architecture	<input type="checkbox"/> Landscape Architecture	<input type="checkbox"/> Social/Humanitarian	_____
<input type="checkbox"/> Art	<input type="checkbox"/> Literature	<input type="checkbox"/> Theater	_____
<input type="checkbox"/> Commerce	<input type="checkbox"/> Military	<input type="checkbox"/> Transportation	_____
<input type="checkbox"/> Communications	<input type="checkbox"/> Music		
<input checked="" type="checkbox"/> Conservation			

STATEMENT OF SIGNIFICANCE

The Silas Casey Farm is a fine example of an 18th-century New England farm. Its working outbuildings, its fields bordered by handsome stone walls and populated by cows and horses, and its fine house are typical of what much of Rhode Island's South County must have been like preceding and directly following the Revolution. In that period the area was the home of the landed merchant-farmer, and was distinguished by a height of culture and activity unknown anywhere else in Rhode Island at that date, with the exception of Newport (with which the South County had considerable contact by water).

The architecture of the Casey house combines the floor plan, framing, and overall simplicity of most mid-18th-century building with a few finer signs of prosperity: including the gable-on-hip roof and the two slant-back, glass-doored fireplace cupboards. The entry hall and stairway are noteworthy both for their handsomeness and for their typicality.

The house was the scene of a Revolutionary skirmish between sailors from a British vessel blockading the west channel of Narragansett Bay and patriotic scouts quartered for the night at the Casey Farm. The British surprised the patriots, but most of them escaped unharmed. The house, however, was riddled with bullet-holes--the parlor door still displaying one such puncture as a reminder.

The Caseys were a distinguished and public-serving family. Silas, for whom the farm was named, was a prosperous Narragansett Bay ship-owner, who sacrificed four of his vessels to Revolutionary privateering. His son, Wanton, fought in the Revolution and was a charter member of the Kentish Guards. Both men were members of the vestry in their churches. Throughout the history of the family, Casey men served in various military and naval capacities in various wars. General Thomas Lincoln Casey (d. 1896) fought in the Civil War and rose thereafter to the post of Chief of Engineers of the U. S. Army. In that position he was charged with strengthening the foundations and completing the top part of the Washington Monument; he also oversaw the construction of the Library of Congress building.

(See Continuation Sheet)

SEE INSTRUCTIONS

NATIONAL REGISTER OF HISTORIC PLACES
INVENTORY - NOMINATION FORM

(Continuation Sheet) - 2

STATE	
Rhode Island	
COUNTY	
Washington	
FOR NPS USE ONLY	
ENTRY NUMBER	DATE

(Number all entries)

8. Significance

The Silas Casey Farm includes nearly three hundred acres of unspoiled woods and fields and for this reason, besides its historical and family associations, is important to any conservation considerations in Rhode Island. This property relates very congenially to public land-holdings on the east (the University of Rhode Island campus) and also to the nearby Narrow River, currently an object of conservation efforts. The land, house and outbuildings of the Casey Farm are fortunately in the ownership and care of the Society for the Preservation of New England Antiquities.

9. MAJOR BIBLIOGRAPHICAL REFERENCES

Casey, Thomas Lincoln (General U. S. A.): The Casey Farm on Boston Neck, Saunderstown (N. p., 1881).
 Casey, Thomas Lincoln (General U. S. A.), Obituary of: In American Architect and Building News, April 18, 1896.
 Meader, Charles A.: "The Casey Family of East Greenwich," in the East Greenwich News, September 5, 1927 (East Greenwich, Rhode Island, 1927).
 National Society of Colonial Dames in the State of Rhode Island and Providence Plantations: Old Houses In the South County of Rhode Island (Providence, Rhode Island, 1932), pp. 5-7.

10. GEOGRAPHICAL DATA

LATITUDE AND LONGITUDE COORDINATES DEFINING A RECTANGLE LOCATING THE PROPERTY			O R	LATITUDE AND LONGITUDE COORDINATES DEFINING THE CENTER POINT OF A PROPERTY OF LESS THAN TEN ACRES		
CORNER	LATITUDE	LONGITUDE		LATITUDE	LONGITUDE	
NW	Degrees Minutes Seconds 41 ° 30 47.47	Degrees Minutes Seconds 71 ° 26 57.54		Degrees Minutes Seconds	Degrees Minutes Seconds	
NE	41 ° 30 49.12	71 ° 24 52.97				
SE	41 ° 30 34.62	71 ° 24 52.75				
SW	41 ° 30 33.30	71 ° 26 57.32				

APPROXIMATE ACREAGE OF NOMINATED PROPERTY: 292 acres

LIST ALL STATES AND COUNTIES FOR PROPERTIES OVERLAPPING STATE OR COUNTY BOUNDARIES

STATE:	CODE	COUNTY	CODE

11. FORM PREPARED BY

NAME AND TITLE:
Ancelin V. Lynch, Surveyor-Researcher

ORGANIZATION: Rhode Island Historical Preservation Commission DATE: November 2, 1972

STREET AND NUMBER:
John Brown House, 52 Power Street

CITY OR TOWN: Providence STATE: Rhode Island, 02906 CODE: 44

12. STATE LIAISON OFFICER CERTIFICATION

NATIONAL REGISTER VERIFICATION

As the designated State Liaison Officer for the National Historic Preservation Act of 1966 (Public Law 89-665), I hereby nominate this property for inclusion in the National Register and certify that it has been evaluated according to the criteria and procedures set forth by the National Park Service. The recommended level of significance of this nomination is:

National State Local

Therese C. Williams
 Name State Historic Preservation Officer

Title _____

Date 5/7/73

I hereby certify that this property is included in the National Register.

 Chief, Office of Archeology and Historic Preservation

Date _____

ATTEST: _____

 Keeper of The National Register

Date _____

SEE INSTRUCTIONS



UNITED STATES DEPARTMENT OF THE INTERIOR
NATIONAL PARK SERVICE
NATIONAL REGISTER OF HISTORIC PLACES
PROPERTY PHOTOGRAPH FORM

(Type all entries - attach to or enclose with photograph)

1. NAME		
COMMON Casey (Silas) Farm	AND/OR HISTORIC	NUMERIC CODE (Assigned by NPS)
2. LOCATION		
STATE Rhode Island	COUNTY Washington	TOWN North Kingstown
STREET AND NUMBER Boston Neck Road, 0.3 miles north of Ferry Road, Saunderstown		
3. PHOTO REFERENCE		
PHOTO CREDIT The Society for the Preservation of New England Antiquities	DATE 1972	NEGATIVE FILED AT The Society for the Preservation of New Eng- land Antiquities, 141 Cam- bridge Street, Boston, Massa- chusetts, 02114
4. IDENTIFICATION		
DESCRIBE VIEW, DIRECTION, ETC. View of farmhouse and outbuildings from the south-west.		



UNITED STATES DEPARTMENT OF THE INTERIOR
NATIONAL PARK SERVICE

NATIONAL REGISTER OF HISTORIC PLACES
PROPERTY PHOTOGRAPH FORM

(Type all entries - attach to or enclose with photograph)

1. NAME		
COMMON	AND/OR HISTORIC	NUMERIC CODE (Assigned by NPS)
Casey (Silas) Farm		
2. LOCATION		
STATE	COUNTY	TOWN
Rhode Island	Washington	North Kingstown
STREET AND NUMBER		
Boston Neck Road, 0.3 miles north of Ferry Road, Saunderstown		
3. PHOTO REFERENCE		
PHOTO CREDIT	DATE	NEGATIVE FILED AT
The Society for the Preservation of New England Antiquities	1972	The Society for the Preservation of New England Antiquities, 141 Cambridge Street, Boston, Massachusetts, 02114
4. IDENTIFICATION		
DESCRIBE VIEW, DIRECTION, ETC.		

Exterior of farmhouse from the south-west.



UNITED STATES DEPARTMENT OF THE INTERIOR
NATIONAL PARK SERVICENATIONAL REGISTER OF HISTORIC PLACES
PROPERTY PHOTOGRAPH FORM*(Type all entries - attach to or enclose with photograph)*

1. NAME		
COMMON	AND/OR HISTORIC	NUMERIC CODE <i>(Assigned by NPS)</i>
Casey (Silas) Farm		

2. LOCATION		
STATE	COUNTY	TOWN
Rhode Island	Washington	North Kingstown

STREET AND NUMBER		
Boston Neck Road, 0.3 miles north of Ferry Road, Saunderstown		

3. PHOTO REFERENCE		
PHOTO CREDIT	DATE	NEGATIVE FILED AT
The Society for the Preservation of New England Antiquities	1972	The Society for the Preservation of New England Antiquities, 141 Cambridge Street, Boston, Massachusetts, 02114

4. IDENTIFICATION		
DESCRIBE VIEW, DIRECTION, ETC.		
Stairway in front entry.		



UNITED STATES DEPARTMENT OF THE INTERIOR
NATIONAL PARK SERVICENATIONAL REGISTER OF HISTORIC PLACES
PROPERTY PHOTOGRAPH FORM*(Type all entries - attach to or enclose with photograph)*

1. NAME		
COMMON	AND/OR HISTORIC	NUMERIC CODE (Assigned by NPS)
Casey (Silas) Farm		
2. LOCATION		
STATE	COUNTY	TOWN
Rhode Island	Washington	North Kingstown
STREET AND NUMBER		
Boston Neck Road, 0.3 miles north of Ferry Road, Saunderstown		
3. PHOTO REFERENCE		
PHOTO CREDIT	DATE	NEGATIVE FILED AT
The Society for the Preservation of New England Antiquities	1972	The Society for the Preservation of New England Antiquities, 141 Cambridge Street, Boston, Massachusetts, 02114
4. IDENTIFICATION		
DESCRIBE VIEW, DIRECTION, ETC.		
Fireplace wall in east parlour, first floor.		

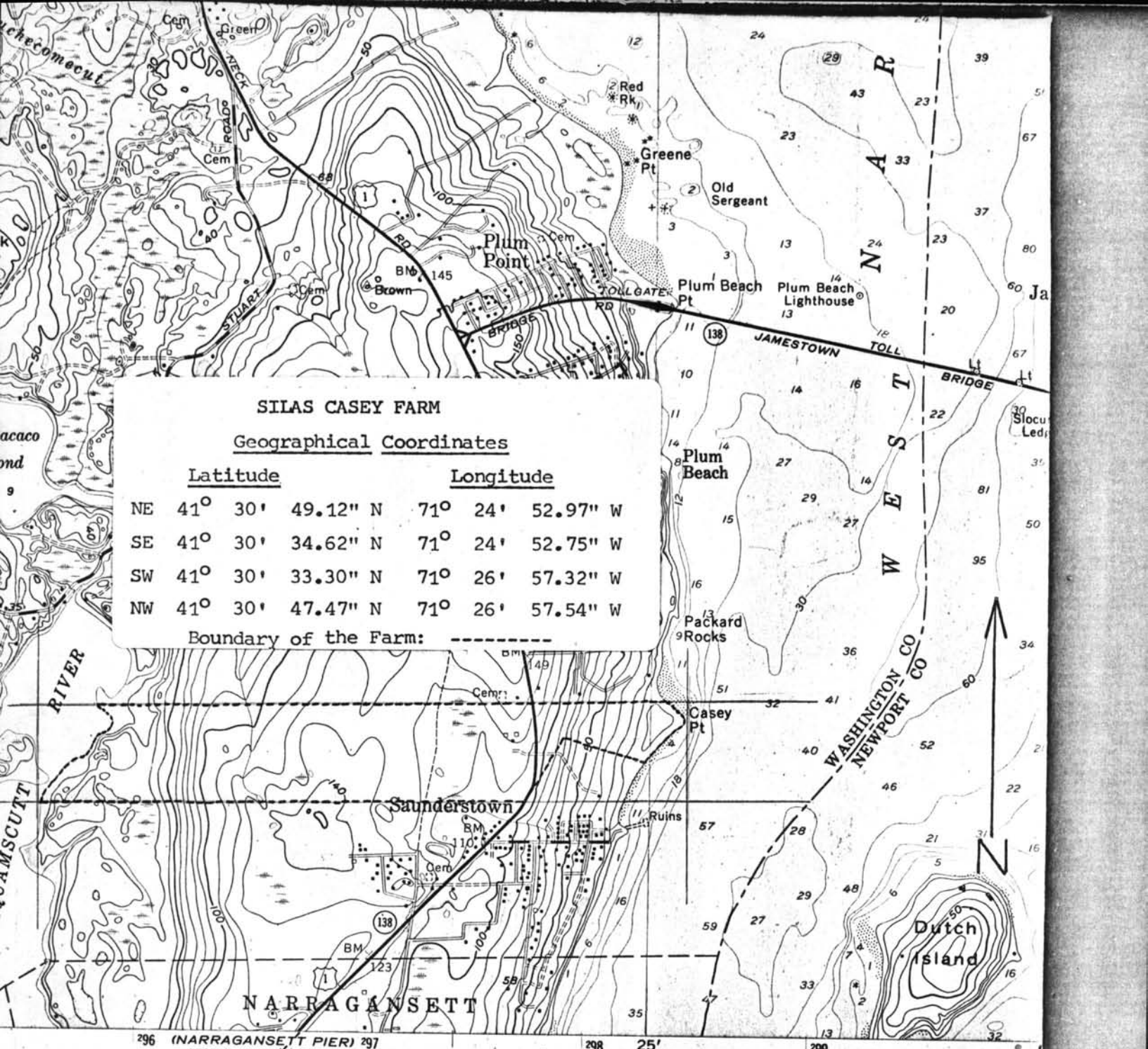

SILAS CASEY FARM

Geographical Coordinates

	<u>Latitude</u>	<u>Longitude</u>
NE	41° 30' 49.12" N	71° 24' 52.97" W
SE	41° 30' 34.62" N	71° 24' 52.75" W
SW	41° 30' 33.30" N	71° 26' 57.32" W
NW	41° 30' 47.47" N	71° 26' 57.54" W

Boundary of the Farm: - - - - -

SCALE 1:24000

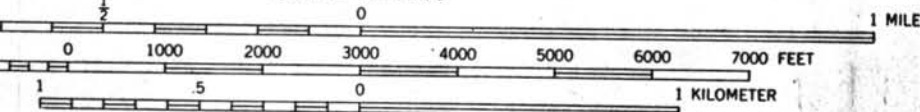

CONTOUR INTERVAL 10 FEET

DATUM IS MEAN SEA LEVEL

DEPTH CURVES AND SOUNDINGS IN FEET—DATUM IS MEAN LOW WATER

SHORELINE SHOWN REPRESENTS THE APPROXIMATE LINE OF MEAN HIGH WATER

THE MEAN RANGE OF TIDE IS APPROXIMATELY 3.8 FEET



QUADRANGLE LOCATION

THIS MAP COMPLIES WITH NATIONAL MAP ACCURACY STANDARDS
 FOR SALE BY U. S. GEOLOGICAL SURVEY, WASHINGTON, D. C. 20242
 FOR DESCRIBING TOPOGRAPHIC MAPS AND SYMBOLS IS AVAILABLE ON REQUEST

NATIONAL REGISTER OF HISTORIC PLACES
PROPERTY MAP FORM

(Type all entries - attach to or enclose with map)

STATE Rhode Island	
COUNTY Washington	
FOR NPS USE ONLY	
ENTRY NUMBER	DATE

SEE INSTRUCTIONS

1. NAME

COMMON: Silas Casey Farm

AND/OR HISTORIC:

2. LOCATION

STREET AND NUMBER:

Boston Neck Road

CITY OR TOWN:

North Kingstown

STATE:

Rhode Island

CODE

44

COUNTY:

Washington

CODE

009

3. MAP REFERENCE

SOURCE:

U.S. Geological Survey

SCALE: 1:24,000

DATE: 1957

4. REQUIREMENTS

TO BE INCLUDED ON ALL MAPS

1. Property boundaries where required.
2. North arrow.
3. Latitude and longitude reference.